

VOLUME 3

TECHNICAL SPECIFICATIONS

REF NO 01/CUAMM/ETH/2025/ AID 012958

Gynecology Block

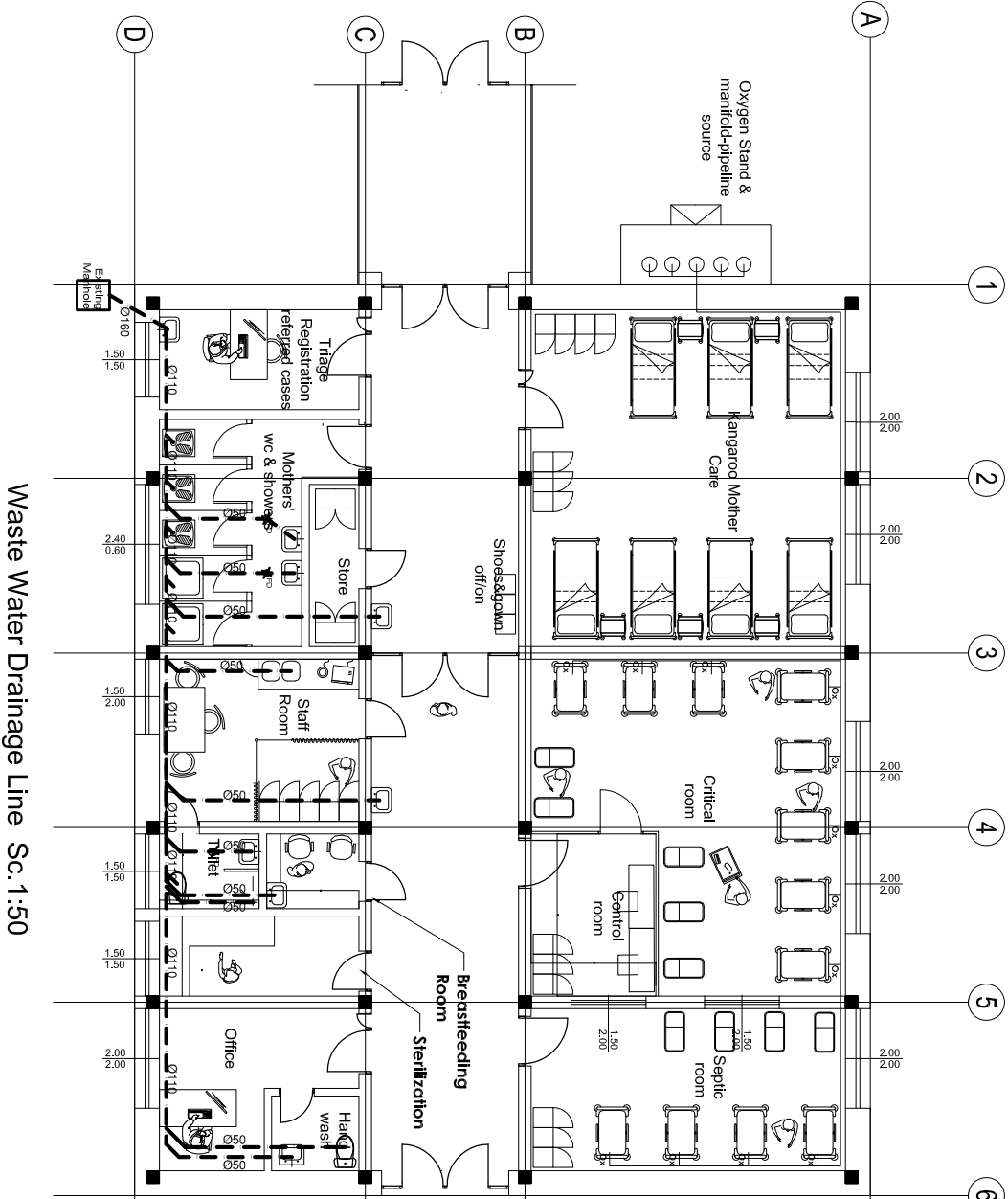

Waste Water Drainage Line Sc.1:50

NOTE

- WASTE WATER**
- Internal waste pipes should be PVC PNB and connected with each other with the necessary fittings.
 - External waste pipes should be UPVC PNB and connected with each other with the necessary fittings.
 - All UPVC pipes must be connected under the slab and covered by suspended ceiling.
 - The following slopes must be met a minimum requirement for UPVC PVC pipes.
 - Provide a minimum of 2.50% slope for Ø50 horizontal drainage pipes.
 - Provide a minimum of 1.25% slope for Ø75 horizontal drainage pipes.
 - Provide a minimum of 1.00% slope for Ø110 horizontal drainage pipes.
 - Provide a minimum of 0.65% slope for Ø125 horizontal drainage pipes.
 - Provide a minimum of 0.65% slope for Ø160 horizontal drainage pipes.
 - Provide a minimum of 0.65% slope for Ø200 horizontal drainage pipes.
 - Waste pipes, which is used to connect Manholes to Manholes, should be UPVC PNB type.
 - All UPVC waste water pipes must not be heater for connection. All piping connection should be made with approved fitting.
 - Waste water take off point for fixtures are provided below:-

Fixture	take off point (m)
H/WB/LS/K/S/UR	+ 0.5
S/H /W/C	+ 0.00

GENERAL NOTES

No.	REVISION / ISSUE	DATE

ARCHITECTURAL DESIGN

PROJECT NAME
SOUTH SHIRE HOSPITAL
NICU REHABILITATION

Project Address
Kempster / Riverside
House No. -

The Client no.:

Project Owner
DOCTORS WITH AFRICA - CUAMM

Project Status
 New Modification As Built

Designed By
Sodomon Tesfay

Drawn By
Staff

Checked By
Staff

Scale
1:50

Date
Dec-2024

Project No.
01/02

Drawing No.
ISO A1